

BPDC

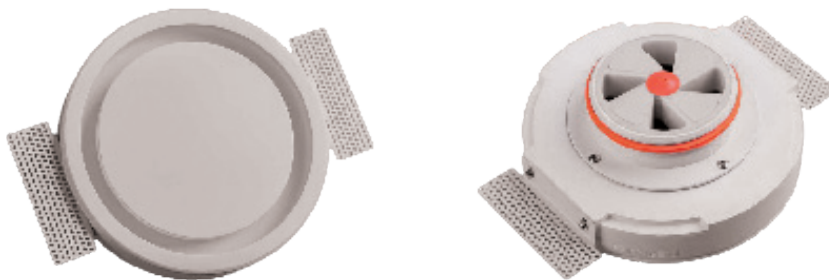

Technisches
Datenblatt
Data sheet

Beschreibung: Rahmenloser, runder Diffusor aus hochwertigem Gips, geeignet für die Installation an Decken oder Gipskartonwänden. Kann in derselben Farbe wie die Oberfläche, auf der er installiert wird, gestrichen werden. Anschlussmöglichkeit an Stahl-, flexible und gewellte Rohre sowie über Kästen. Verwendbar auf einlagigem, zweilagigem oder unterschiedlich dickem Gipskarton. Ausgestattet mit robusten Magnethaltern aus Edelstahl. Seitliche Rippen zur Befestigung im Putz.

Description: frameless circular diffuser in high quality plaster suitable for installation on plasterboard ceilings or walls. It can be painted the same color as the surface on which it is installed. Connectable with steel, flexible, corrugated ducts and Kasten boxes. Can be used on single, double layer or variable thickness plasterboard. Equipped with robust magnetic supports in stainless steel. Side fins for fixing in the stucco.



ZEICHNUNGEN | DRAWINGS

BPDC 120 - 125

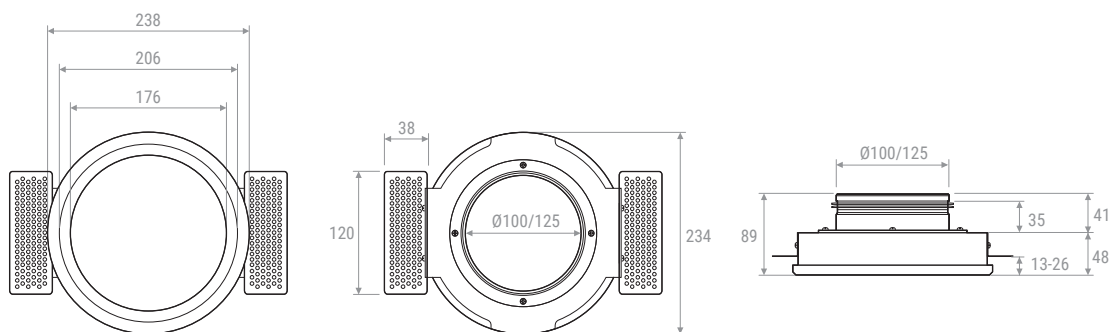



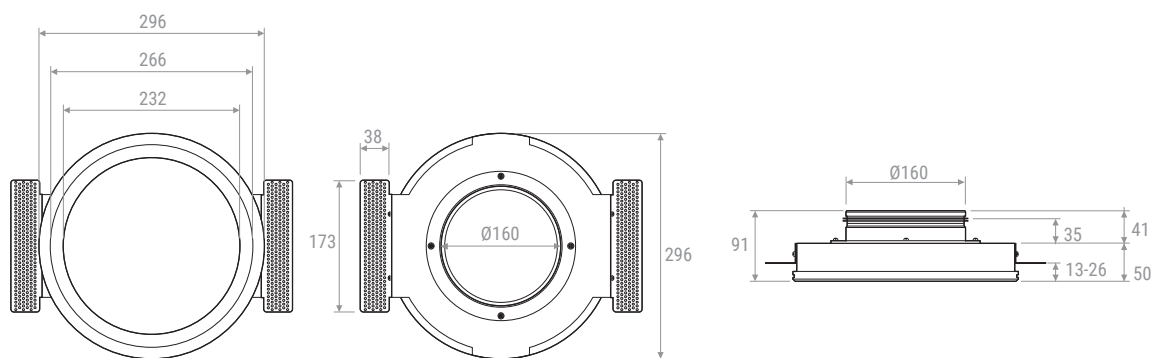



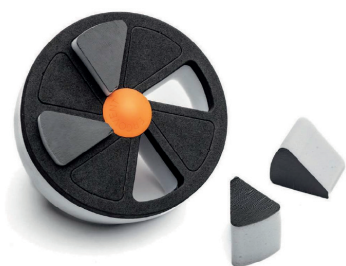

BPDC 160

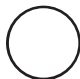

ACCESSORIES - DOMESTIC

KLAPPE | DAMPER



	<p>D0</p>  <p>Keine Klappe No damper</p>	<p>D1</p>  <p>1 Segment 1 segment</p>	<p>D2</p>  <p>2 Segmente 2 segments</p>	<p>D3</p>  <p>3 Segmente 3 segments</p>
	<p>D4</p>  <p>4 Segmente vollständig geöffnet 4 segments full open</p>	<p>D5</p>  <p>4 Segmente 75% geöffnet 4 segments 75% open</p>	<p>D6</p>  <p>4 Segmente 50% geöffnet 4 segments 50% open</p>	<p>D7</p>  <p>4 Segmente 25% geöffnet 4 segments 25% open</p>



PLUGBPD 100 - 125

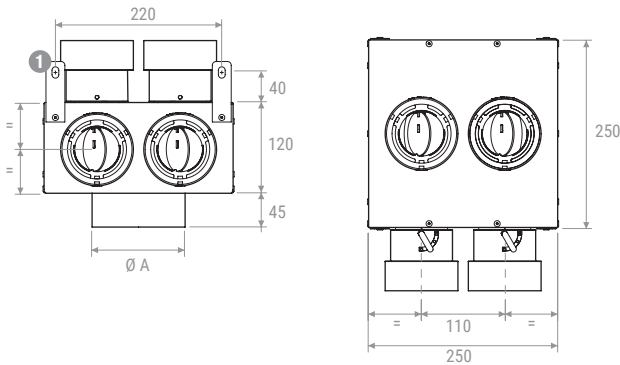

Ø A

mm

100

125

Kasten aus verzinktem Blech, vorbereitet für obere oder seitliche Anschlüsse, Kit mit 2 Anschlüssen und 2 Verschlusskappen.
Kasten box made in galvanized steel prepared for spigot upper or lateral kit complete of 2 spigots and 2 caps.

PLUGBPD 160

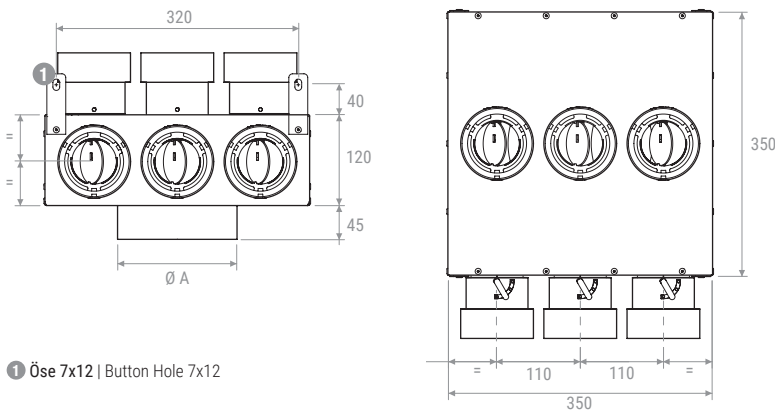

Ø A

mm

160

Kasten aus verzinktem Blech, vorbereitet für obere oder seitliche Anschlüsse, Kit mit 3 Anschlüssen und 3 Verschlusskappen.
Kasten box made in galvanized steel prepared for spigot upper or lateral kit complete of 3 spigots and 3 caps.

1 Öse 7x12 | Button Hole 7x12

LEISTUNGSDIAGRAMME | PERFORMANCE CHARTS

BPDC 100 LUFTZUFUHR | SUPPLY AIR

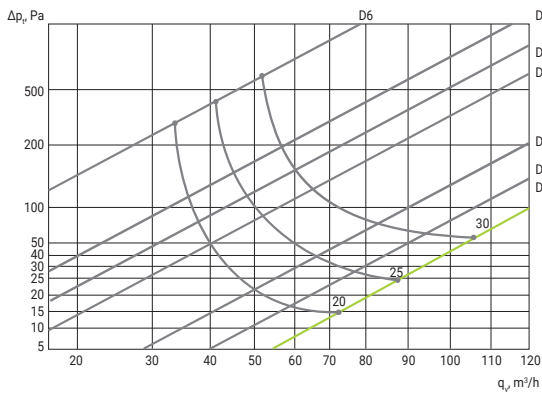

BPDC 125 LUFTZUFUHR | SUPPLY AIR

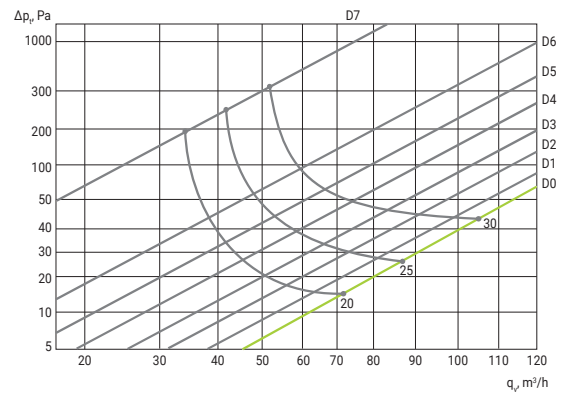

BPDC 100 LUFTRÜCKFÜHRUNG | RETURN AIR

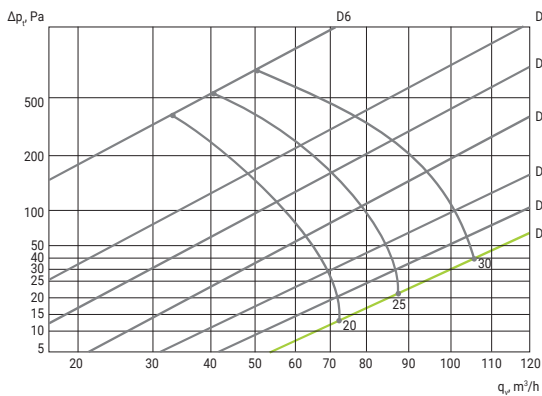

BPDC 125 LUFTRÜCKFÜHRUNG | RETURN AIR

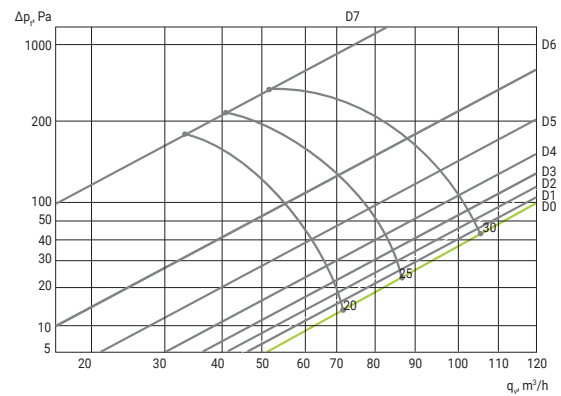

BPDC 100/125 GESCHWINDIGKEIT | VELOCITY m/s

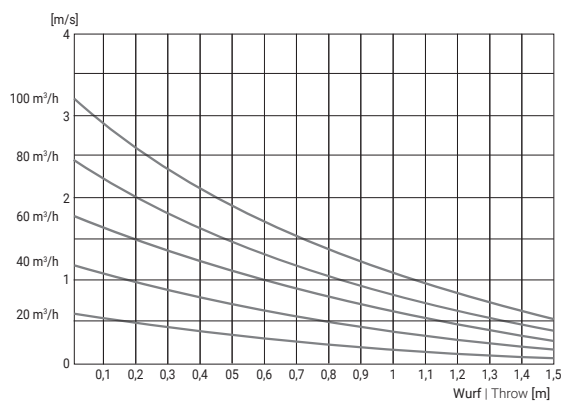

BPDC 160 LUFTZUFUHR | SUPPLY AIR

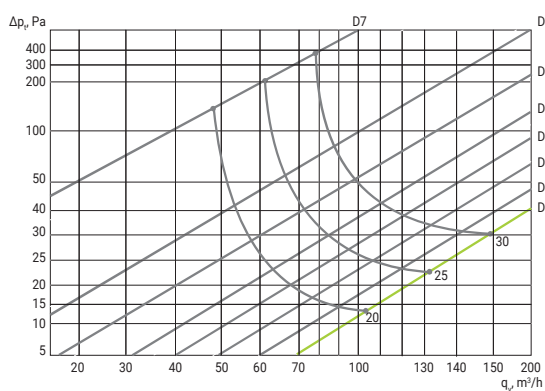

BPDC 160 LUFTRÜCKFÜHRUNG | RETURN AIR

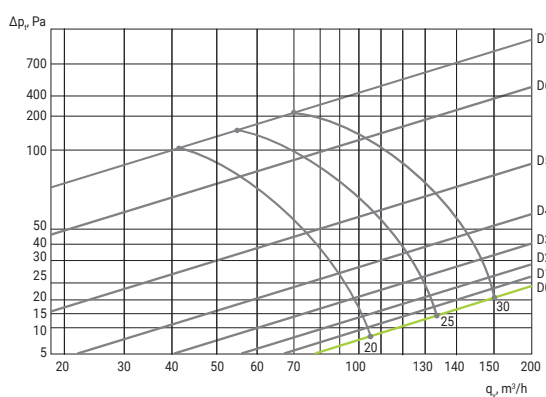

BPDC 160 GESCHWINDIGKEIT | VELOCITY m/s

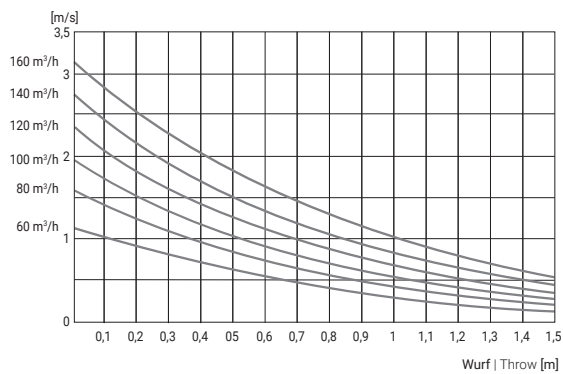

ACCESSORIES - DOMESTIC

PREISE | PRICES

Modell Model	€
BPDC100	
BPDC125	
BPDC160	
PLUGBPD100	
PLUGBPD125	
PLUGBPD160	

